

# Customer Information Sheet

DRAWING No.: BH-002XXXX

SHEET 2 OF 2

IF IN DOUBT - ASK

©

NOT TO SCALE

THIRD ANGLE PROJECTION

ALL DIMENSIONS IN mm

BH-0021235

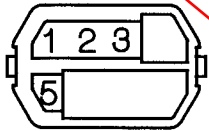

COLOUR:  
OCHRE YELLOW

MATING MALE CODING KEY:  
BH-0014678

BH-0021278

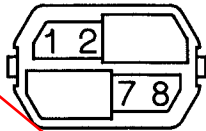

COLOUR:  
CADMIUM YELLOW

MATING MALE CODING KEY:  
BH-0013456

BH-0022457

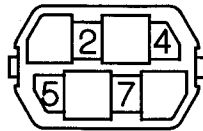

COLOUR:  
YELLOW GREEN

MATING MALE CODING KEY:  
BH-0011368

BH-0024578

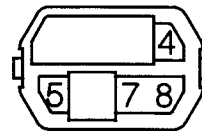

COLOUR:  
NUT BROWN

MATING MALE CODING KEY:  
BH-0011236

**OBSOLETE**

BH-0021247

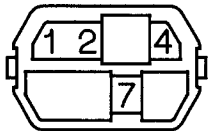

COLOUR:  
PASTEL ORANGE

MATING MALE CODING KEY:  
BH-0013568

BH-0021346

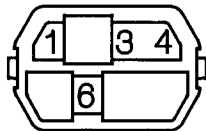

COLOUR:  
RESEDA GREEN

MATING MALE CODING KEY:  
BH-0012578

BH-0022478

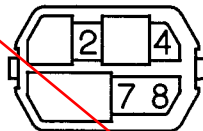

COLOUR:  
LILAC BLUE

MATING MALE CODING KEY:  
BH-0011356

BH-0021256

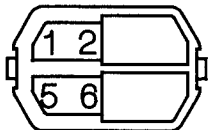

COLOUR:  
STEEL BLUE

MATING MALE CODING KEY:  
BH-0013478

BH-0022348

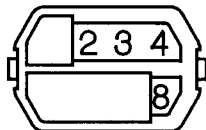

COLOUR:  
BRILLIANT BLUE

MATING MALE CODING KEY:  
BH-0011567

BH-0023567

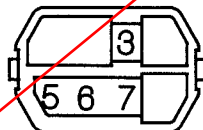

COLOUR:  
STRAWBERRY RED

MATING MALE CODING KEY:  
BH-0011248

BH-0021258

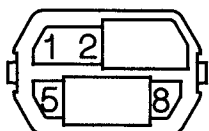

COLOUR:  
SLATE GREY

MATING MALE CODING KEY:  
BH-0013467

**NOTES:**

1. FOR USE WITH TYPE A HARD METRIC CONNECTORS (BH-590XX22 AND BH-591XX22 SERIES).
2. EQUIVALENT MALE CODING KEYS ARE DETAILED ABOVE.
3. FOR COMPLETE SPECIFICATION, SEE COMPONENT SPECIFICATION C038XX (LATEST ISSUE).

SECTION X-X

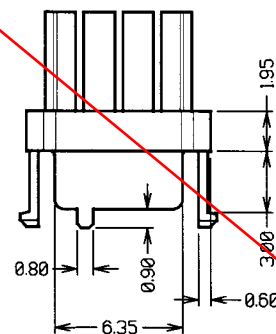
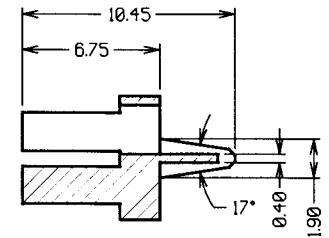
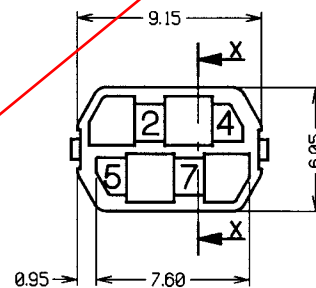

WJB	1	03.04.02	----
NAME	ISS.	DATE	C/NOTE
APPROVED: <i>[Signature]</i>			
CHECKED: <i>[Signature]</i>			
DRAWN: W. J. BOURNE			
CUSTOMER REF.:			
ASSEMBLY DRG:			

**HARWIN**

HARWIN INC  
U.S.A.  
TEL: (812) 285 0055  
FAX: (812) 285 0056

HARWIN PLC  
UK  
TEL: 023 9237 0451  
FAX: 023 9231 4590

HARWIN PTE  
SINGAPORE  
TEL: 65 7794909  
FAX: 65 7793868

THIS DRAWING AND ANY INFORMATION OR DESCRIPTIVE MATTER SET OUT HEREON ARE CONFIDENTIAL AND COPYRIGHT PROPERTY OF THE HARWIN GROUP AND MUST NOT BE DISCLOSED, LOANED, COPIED OR USED FOR MANUFACTURING, TENDERING OR FOR ANY OTHER PURPOSE WITHOUT THEIR WRITTEN PERMISSION.

TOLERANCES  
X. = ±1mm  
X.X = ±0.25mm  
X.XX = ±0.10mm  
X.XXX = ±0.01mm  
ANGLES = ±5°  
UNLESS STATED

MATERIAL:  
15% GLASS-FILLED PBT,  
UL94V-0  
FINISH: CLEAN  
S/AREA: mm<sup>2</sup>

TITLE: HARD METRIC FEMALE CONNECTOR CODING KEY FOR TYPE A  
DRAWING NUMBER: BH-002XXXX  
SHT 2 OF 2