

Customer Information Sheet

DRAWING No.: 8S252#XXXX

SHEET 1 OF 2

IF IN DOUBT - ASK

(C)

NOT TO SCALE

THIRD ANGLE PROJECTION

ALL DIMENSIONS IN mm (INCHES)

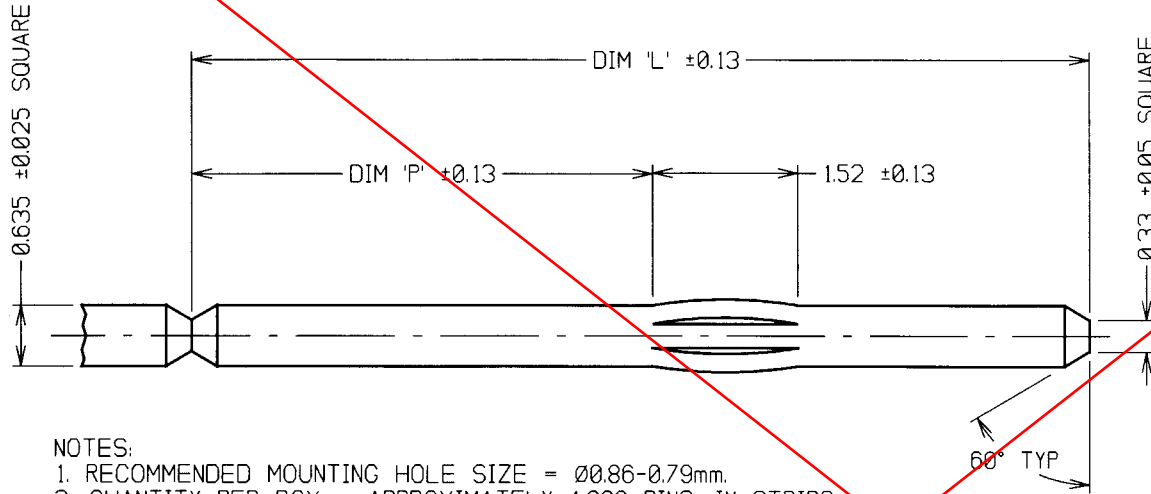

ORDER CODE:
8S252#XXXX

FINISH:
 G = GOLD
 F = 90/10 TIN/LEAD

DIM 'L' IN INCHES _____
 DIM 'P' IN INCHES _____

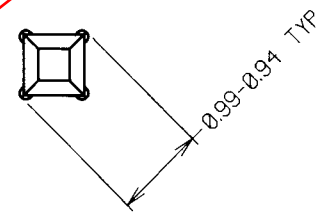

NOTES:

1. RECOMMENDED MOUNTING HOLE SIZE = $\varnothing 0.86-0.79\text{mm}$.
2. QUANTITY PER BOX = APPROXIMATELY 1,000 PINS, IN STRIPS.
3. FOR TOOLING INSTRUCTIONS ON PIN INSERTION PUNCH Z1016-XX, SEE INSTRUCTION SHEET IS-23.

OBSOLETE

PART No.	FINISH
8S252FXXXX	3 μ MIN 90/10 TIN/LEAD OVER 1.3 μ NICKEL
8S252GXXXX	0.13 μ GOLD OVER 1.3 μ NICKEL

PART No.	DIM 'L'	DIM 'P'	TOOL No.
8S252#4130	10.41 (0.41")	7.62 (0.30")	Z1016-30
8S252#4938	12.45 (0.49")	9.65 (0.38")	Z1016-38
8S252#6438	16.26 (0.64")	9.65 (0.38")	Z1016-52
8S252#6452	16.26 (0.64")	13.21 (0.52")	
8S252#7752	19.56 (0.77")	13.21 (0.52")	
8S252#9652	24.38 (0.96")	13.21 (0.52")	

JAE	1	23.07.03	----
NAME	ISS.	DATE	REV./NOTE
APPROVED: <i>[Signature]</i>			
CHECKED: <i>[Signature]</i>			
DRAWN:		J. EVANS	
CUSTOMER REF.:			
ASSEMBLY DRG:			

HARWIN

HARWIN INC U.S.A. TEL: (812) 285 0055 FAX: (812) 285 0056	HARWIN PLC U.K. TEL: 023 9237 0451 FAX: 023 9231 4590	HARWIN PTE SINGAPORE TEL: 65 7794909 FAX: 65 7793868
--	--	---

THIS DRAWING AND ANY INFORMATION OR DESCRIPTIVE MATTER SET OUT HEREON ARE CONFIDENTIAL AND COPYRIGHT PROPERTY OF THE HARWIN GROUP AND MUST NOT BE DISCLOSED, LOANED, COPIED OR USED FOR MANUFACTURING, TENDERING OR FOR ANY OTHER PURPOSE WITHOUT THEIR WRITTEN PERMISSION.

TOLERANCES
 X. - $\pm 1\text{mm}$
 X.X - $\pm 0.25\text{mm}$
 X.XX - $\pm 0.10\text{mm}$
 X.XXX - $\pm 0.01\text{mm}$
 ANGLES - $\pm 5^\circ$
 UNLESS STATED

MATERIAL:
 PHOSPHOR BRONZE CDA-510
 ALLOY GRADE A 3/4 HARD

FINISH: SEE TABLE

S/AREA: mm²

TITLE:
 END-TO-END PIN
 (STRIP PACKING)

DRAWING NUMBER:
8S252#XXXX